

Exhaust High Pressure Ventilating Fan/Shutter

Drawing

- Exhaust High Pressure Ventilating Fan

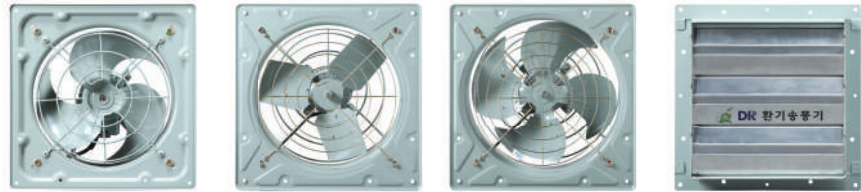
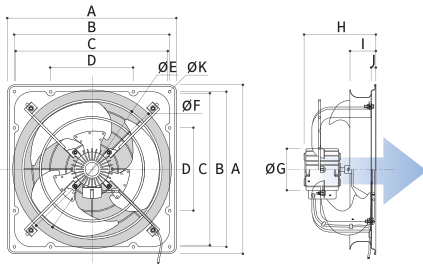

- Shutter

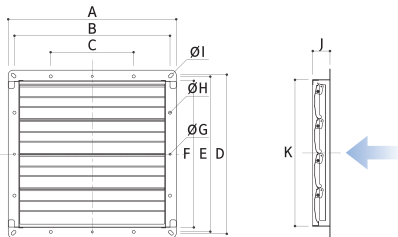

- Lightweight, corrosion resistant and dustproof, made from aluminum
- No operating noise
- Suitable for controlling wind volume, blocking inflow of air, and preventing rain and dust from entering high pressure fans

Dimension

(Unit:mm)

Model No.	A	B	C	D	E	F	G	H	I	J	K	Wt(kg)
DR-DF20ASB	300	275	270	120	215	250	105	163	51	13	6	
DR-DF25ASB	350	325	314	160	265	310	105	165	61			
DR-DF30BSB/BSD	400	370	364	200	305	355	105	168	63			
DR-DF35CSB/CSD	440	400	400	200	355	410	120	200	64			
DR-DF40DSC	490	450	450	240	405	465	120	215	75	14	8	
DR-F45DSA												
DR-F50FSA	620	560	560	280	475	535	162	270	120	11.5	12	
DR-G50DSA												
SHUTTER(8')	296	275	-	275	-	232	6	-	8	50.4	235	1.0
SHUTTER(10')	346	314	160	325	-	282		285			1.2	
SHUTTER(12')	396	364	200	370	-	332		335			1.4	
SHUTTER(14')	435	400	200	412	400	372		375			1.6	
SHUTTER(16')	486	450	240	160	450	422		425	1.9			
SHUTTER(20')	610	560	280	570	550	502		12	12	63.2	505	4.4